

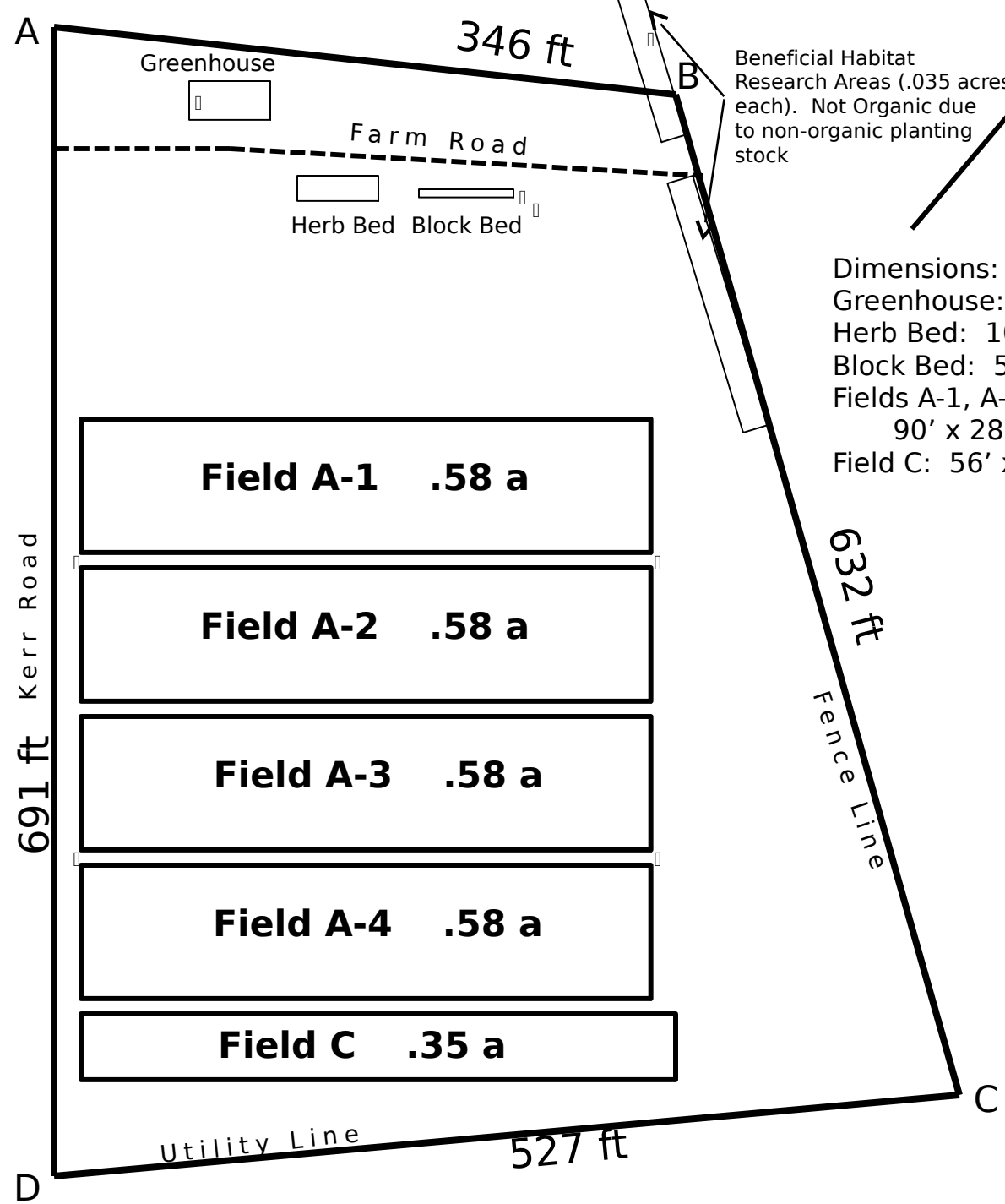

# CANNON HORTICULTURE PROJECT





# Kerr Center's Cannon Horticulture Plots

## 2013 Boundaries & Dimensions

**Total area: 6.67 acres**

**Dimensions:**  
 Greenhouse: 22' x 30'  
 Herb Bed: 10' x 32'  
 Block Bed: 5' x 38'  
 Fields A-1, A-2, A-3, B: 90' x 282'  
 Field C: 56' x 308'

**Buffering:**  
 All fields and beds have 25 feet of organically managed buffer. The Greenhouse has 15 feet of organically managed buffer on the NW side. However, no doors or air intakes occur on that side.

**Corners:**  
 Corner A is at the lowest point in the drainage ditch, 79 feet NW from the center of the farm road. Corner B is on the fence line, 48 feet NW from the center of the farm road. Corner C is a large utility pole at the junction of the fence line and the utility line. Corner D is at the lowest point in the drainage ditch, where it intersects with the utility line.

□ Denotes Hydrants/Irrigation access  
 ━━━ = approx. 50 ft

**Kerr Center's  
Cannon Horticulture Plots**

**Crops and Cover Crops  
DURING THE GROWING  
SEASON  
**2011-2014****

**A-1** 2011: Early Vegetables  
2012: Summer Cover Crop  
2013: Late Vegetables  
2014: Summer Cover Crop

**A-2** 2011: Summer Cover Crop  
2012: Early Vegetables  
2013: Summer Cover Crop  
2014: Late vegetables

**A-3** 2011: Late Vegetables  
2012: Summer Cover Crop  
2013: Early Vegetables  
2014: Summer Cover Crop

**A-4** 2011: Summer Cover Crop  
2012: Late Vegetables  
2013: Summer Cover Crop  
2014: Early vegetables

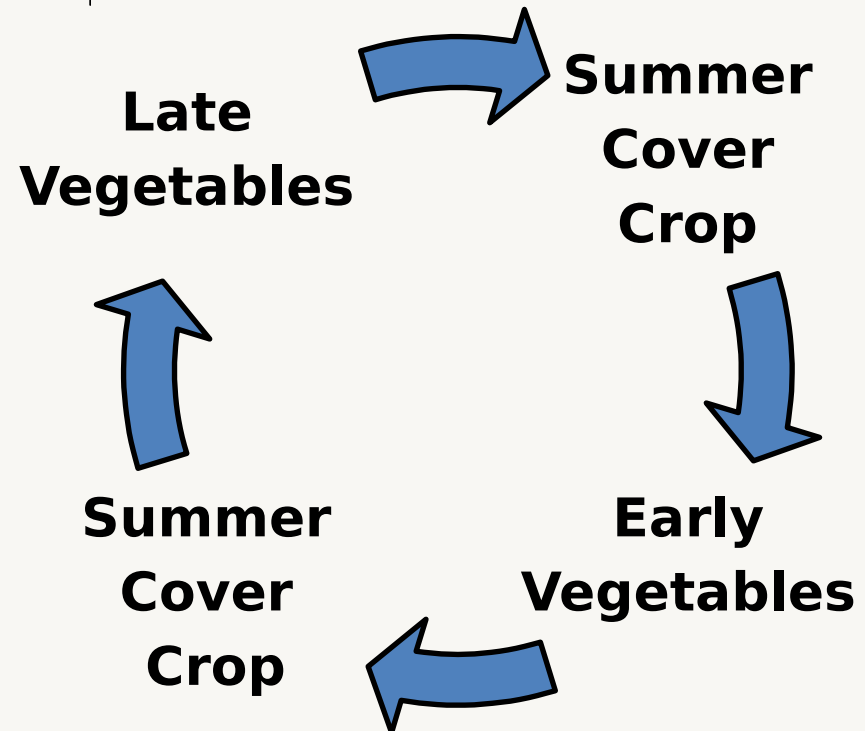

# Sorghum- Sudangrass

Green fallow crops suppress bermudagrass and other weeds, build the soil as a green manure, protect against erosion, provide beneficial insect habitat, serve as a source of uncontaminated mulch for vegetable crops when needed.



Seth Stallings, Student Intern, 2010

# FIELD A1 2013

Current: 7/22/13

## Cover Crop Layout & Kill Method

Each cover crop plot is 28 X 85 ft or .055 acre

Each treatment plot within the cover crop is 14 X 85 ft or .0275 acre

Each plot was seeded by broadcasting and disking the seed in w/BCS disk. Block weights were used on the disk for the lablab, soy, cowpeas & buckwheat. Weight was removed for all the other seeds.

85 ft ← ← Kerr Road → →

	Mowed	Rolled	Mowed	Rolled	Mowed	Rolled	Mowed	Rolled	Mowed	Rolled	Mowed	Rolled	Mowed	Rolled	Mowed	Rolled
Lablab	Viking Soybeans	German Foxtail Millet	Iron & Clay Cowpeas	Japanese Millet	Red Ripper Cowpeas	Pearl Millet	Sesame	Buckwheat	Crotalaria							
Seeded 5/28	Seeded 5/28	Seeded 5/28	Seeded 5/28	Seeded 5/29	Seeded 5/28	Seeded 5/29	Seeded 5/29	Seeded 5/28	Seeded 5/29							
Planting failed due to excessive rains. Replanted to Shallu 7/1.	"Killed" 7/19 Pumpkins planted 7/22	Planting failed due to excessive rains. Replanted to Shallu 7/1.		"Killed" 7/19 Pumpkins planted 7/22				"Killed" 7/1 Pumpkins Planted 7/2								
						Proso Millet										
						Seeded 5/29										
						Failed due to poor stand. Mowed 7/11										

282 ft





**Crimper/Roller**



**Sickle Bar Mower**

